

## POWER LEADS

The RED clip connects to the POS terminal on a 12 volt battery. The BLACK clip connects to the NEG battery terminal. The power should be at least 10 volts, and not over 16 volts, to assure reliable operation. Current draw is 0.2 amp without the flash, and about 0.5 amp while flashing at 1800 RPM. Strobe flash intensity is regulated and is not affected by voltage. The light will not be harmed if the leads are connected incorrectly.

## INDUCTIVE SPARK PICKUP

Latch the pickup around the reference spark plug wire (usually #1) so that spark current impulses are detected. The best pickup arrangement is next to the distributor with the label facing toward the spark plug end. This provides the cleanest signal and keeps the pickup away from the hot exhaust manifold.

Leave the Pickup Latch Open when not in use.

The magnetic cores are made of ferrite ceramic and, when kept apart, they are less likely to break if the pickup is dropped.

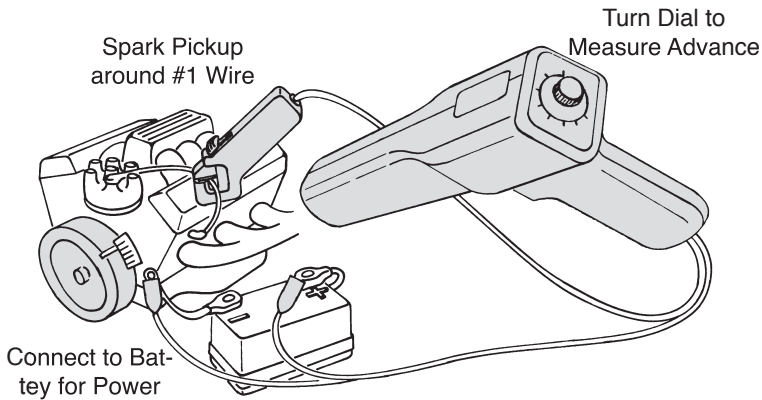

## MAINTENANCE, REPAIR, & TECH SUPPORT

When cleaning the timing light, use a cloth dampened with waterless hand cleaner. DO NOT use solvents such as acetone and benzene, which can be absorbed by and damage plastics. Promptly remove penetrating oils, gasoline, and battery acid.

For repair service or support, contact Ferret Instruments, Inc. at (800) 627-5655, or (231) 627-5664, 1310 Higgins Drive, Cheboygan, MI 49721

## Get a Molded Black Plastic Storage Case for \$12.00

Send this coupon along with: the UPC code, a copy of your receipt, the serial number of the timing light, and a check or money order for \$12 to the address listed to the right. A Storage case will be shipped promptly via the United States Postal System. Offer good only in the United States. Allow 4 weeks for delivery.

# Ferret 82

## Advance Timing Light

### Eluminator™ Optics

5 Times the brightness of ordinary Timing Lights

### Durable Spark Pickup

Glass Reinforced Plastic resists heat and protects you from electrical shock

### Dial Advance to 60°

Calibrated Dial assures accuracy

### 2 Cycle/4 Cycle

Dial label shows 2 cycle & 4 cycle degrees

### Durable ABS Housing

Protects the timing light from accidents

### Designed for the Pro

Stands up to repeated use

### Tech Support Hotline

(800) 627-5655

## 2 Year Limited Warranty

GxT, Inc.  
520 MM Riggs Road  
Cheboygan, MI 49721  
(800) 627-5655  
Fax (231) 627-2727  
www.gxtauto.com



# ***Ferret 82S*** Advance Timing Light

## SAFETY PRECAUTIONS

- Do not look into the light beam. Internal eye burns may be the result. The pain usually starts in a day or two.
  - Do not touch rotating engine parts that appear stopped or slowed under the strobe light flashes.
  - Always wear an eye shield when testing vehicles. Be extra careful near batteries and moving parts.
  - Battery gas is highly explosive.
    - a. If a battery explodes, flush the acid away from person's skin with generous amounts of water. Follow up with a neutralizing solution of baking soda and then more water. Medical treatment for acid burns may be necessary.  
Treat clothing, vehicle parts, and equipment similarly. Any acid traces inside equipment must be removed by generous rinsing. Dry off equipment afterwards and place in a warm 50° C (120° F) oven until thoroughly dry.
    - b. Never use a wrench on the ungrounded battery terminal until the grounded one has been disconnected. Contact between the vehicle body metal and the "hot" terminal can cause sparks to ignite gas or even weld tools into a battery short circuit.
    - c. Keep the space around a battery well ventilated.
    - d. Do not make sparks or allow flames near batteries.
  - Before working on a vehicle, set the brakes and block the wheels. Beware of automatic parking brake releases.
  - Keep your work area well ventilated and free of exhaust. Engine exhaust contains deadly poisons.
  - Avoid electrical shocks caused by getting too close to live ignition wires or touching the coil TACH terminal. A person's reaction near a running engine can be more damaging than the shock.
  - Keep spark producing devices at least 0.5m (18") above the floor to reduce the hazard of igniting gasoline vapor.
  - Do not let test leads wind up in a fan or pulley. Route leads away.
  - Remove finger rings and metal wristbands. They can short terminals and become very hot from electric current.
- 

## FERRET BRAND LIMITED PRODUCT WARRANTY

GxT, Inc. of Cheboygan Michigan, warrants to the original purchaser that FERRET brand products are free from defects in materials and workmanship for a period of two years from date of purchase. Our sole obligation for a product within the above warranties will be to repair or replace, at our option, any defective parts and return the product to the sender within the U.S.A., shipping prepaid, if it is sent to our Repair Department shipping prepaid and accompanied by proof of purchase.

This Warranty does not apply to products which have been altered outside the factory; or repaired by anyone other than the factory or its authorized service centers; or which have been damaged from accidents, negligence, or abuse; or have been used differently than described in the printed instructions. Please note that wear and tear on leads and replacement of consumable items such as: NOx Sensors, Oxygen Sensors, and paper, is not covered by warranty.

GxT Inc.'s sole liability and buyer's exclusive remedy is limited to repair or replacement of the product as stated in the Limited Product Warranty. THERE ARE NO OTHER WARRANTIES EXPRESSED OR IMPLIED INCLUDING THOSE OF MERCHANTABILITY OR FITNESS FOR A PARTICULAR PURPOSE AND GxT, INC. SHALL NOT BE LIABLE FOR INCIDENTAL OR CONSEQUENTIAL DAMAGES ARISING FROM THE SALE OR USE OF THE PRODUCT.

Some states do not allow limitations on the length of implied warranties nor exclusion or limitations of incidental or consequential damages, so that the above limitations and/or exclusion may not apply to you.

This warranty gives you specific legal rights and you may also have other rights which may vary from state to state.